

DURSLEY MARKET PLACE PAVING PROJECT

Delivered through the Dursley Project Group

- Dursley Town Council
- Stroud District Council
- Gloucestershire County Council
- Dursley Town Trust
- Vale Vision

AIM

The aim of the project is to:

- Complement the historic features of the site.
- Clearly direct traffic exiting from Parsonage Street through to Castle Street.
- Inhibit illegal access through the No Entry where Parsonage Street meets Castle Street
- Suitable for pedestrian movement i.e. does not create a slip or trip hazard.
- Suitable for vehicle purpose i.e. vehicle weight and manoeuvring.

PROCESS



| |
|--|
| Agree partnership organisations |
| Develop and agree consultancy brief for architectural and engineering drawings |
| Award contract for architectural and engineering drawings |
| Development of draft architectural drawings |
| Key Stakeholder and Public consultation |
| Finalise architectural drawings |
| On basis of architectural drawings develop engineering drawings |
| Drawings certified by GCC |
| Develop and finalise brief for civil works |
| Award contract |
| Civic construction occurs |
| Completion and adoption by GCC |

CONSULTATION

- Discussion with Key Stakeholders
 - Stroud and District Access Group
 - Dursley Town Trust
 - Vale Business Forum
 - Gloucestershire Police
 - Elected Representatives
- Press Release and radio interview
- Public consultation to guide preferred option
 - Letter to businesses & personal discussions
 - Posters in town centre
 - Event Times
 - Tuesday 10th 4pm
 - Tuesday 10th 7.30pm
 - Wednesday 18th 7pm
 - All at Dursley Methodist Church Hall

The Market Place: Proposals - Option 1

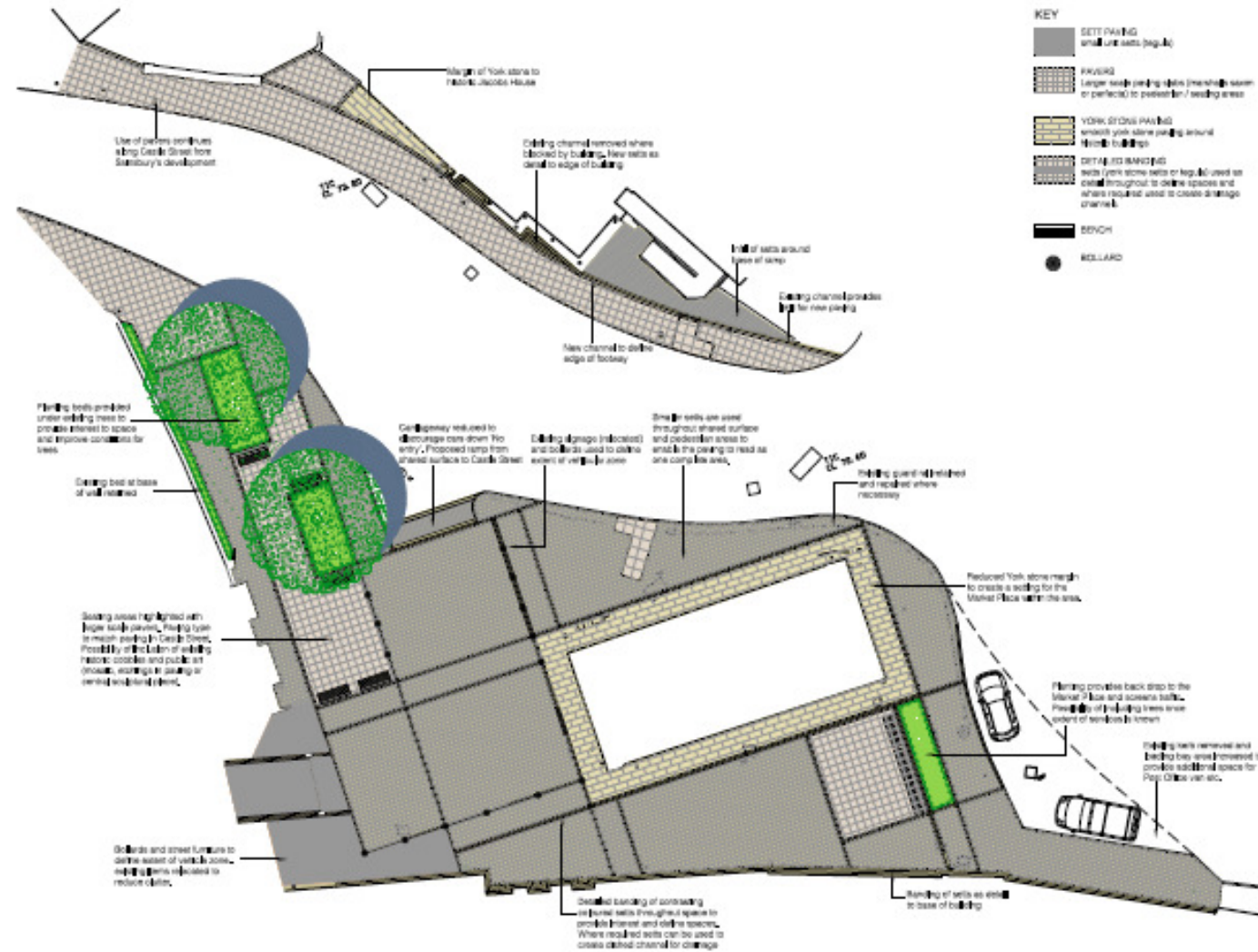

The Market Place: Proposals - Option 2

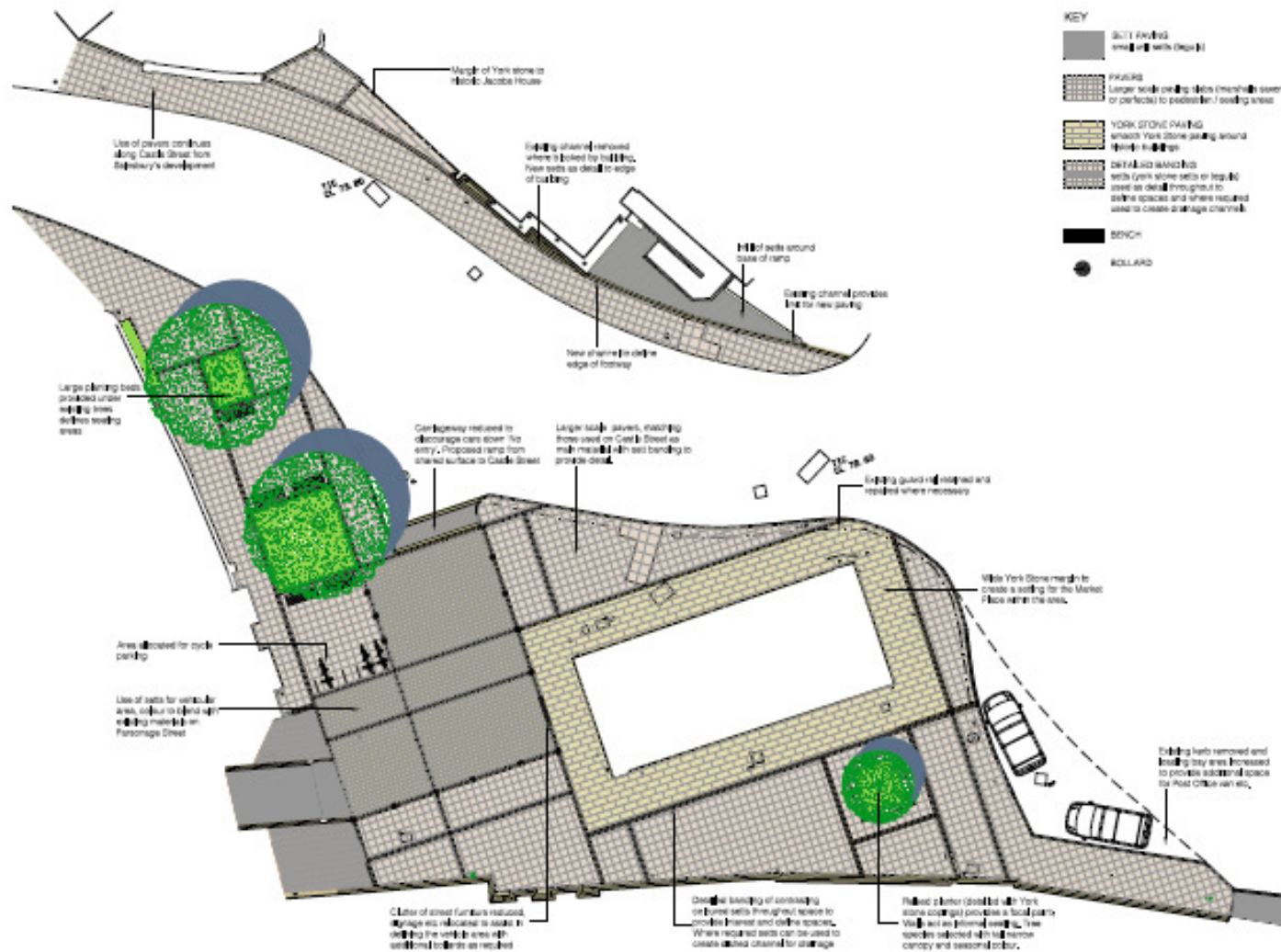

2830/ SK03

DURSLEY PAVING PROJECT

The Dursley project MUST deliver:

- Accessibility of large lorries from Parsonage Street onto Castle Street
- A paving surface which avoids trip hazards and does not have a variety of level changes allowing greater flexibility of the space.
- A paving surface which discourages (in accordance with adopted traffic regulation) access from private cars where the occupant is not a blue badge holder
- York Stone paving around the Old Town Hall/ Market Place in keeping with the historic building
- Re-inforced paving where there is permitted vehicle traffic; zone defined by bollards / street furniture and banding within the paving design
- Narrowed opening and new traffic calming at junction of Castle and Parsonage Street which more distinctly inhibits illegal access across the 'No Entry'
- A surface camber which directs overland flow to designated drainage formed by channels in the paving design.
- Existing memorial plaques retained and relocated within proposals
- An increased loading bay on Silver Street

CONSULTATION TESTS THE FOLLOWING OPTIONAL COMPONENTS

- 2 Overall Concept Drawings
- 4 Paving Suite Options
- Wider or Narrower (squared-off) York Stone width around the Old Town Hall
- Inclusion or exclusion of a bike parking facility
- What range of street furniture
- Planting
 - A tree in a raised planter (also acts as seating) close to the Silver Street loading bay, or a planting bed is included close to the Silver Street loading bay, or no new tree planting in that area
 - Retention or removal of planting bed at base of wall of existing brick wall